

**This electronic collection of documents is provided  
for the convenience of the user  
and is Not a Certified Document –**

**The documents contained herein were originally issued  
and sealed by the individuals whose names and license  
numbers appear on each page, on the dates appearing  
with their signature on that page.**

**This file or an individual page  
shall not be considered a certified document.**

2018-2019  
Franklin County  
Chip Seal



PROJECT REFERENCE NO. 2017CPT.05.22.20352.1, etc.	SHEET NO. <u>1</u>
--	-----------------------

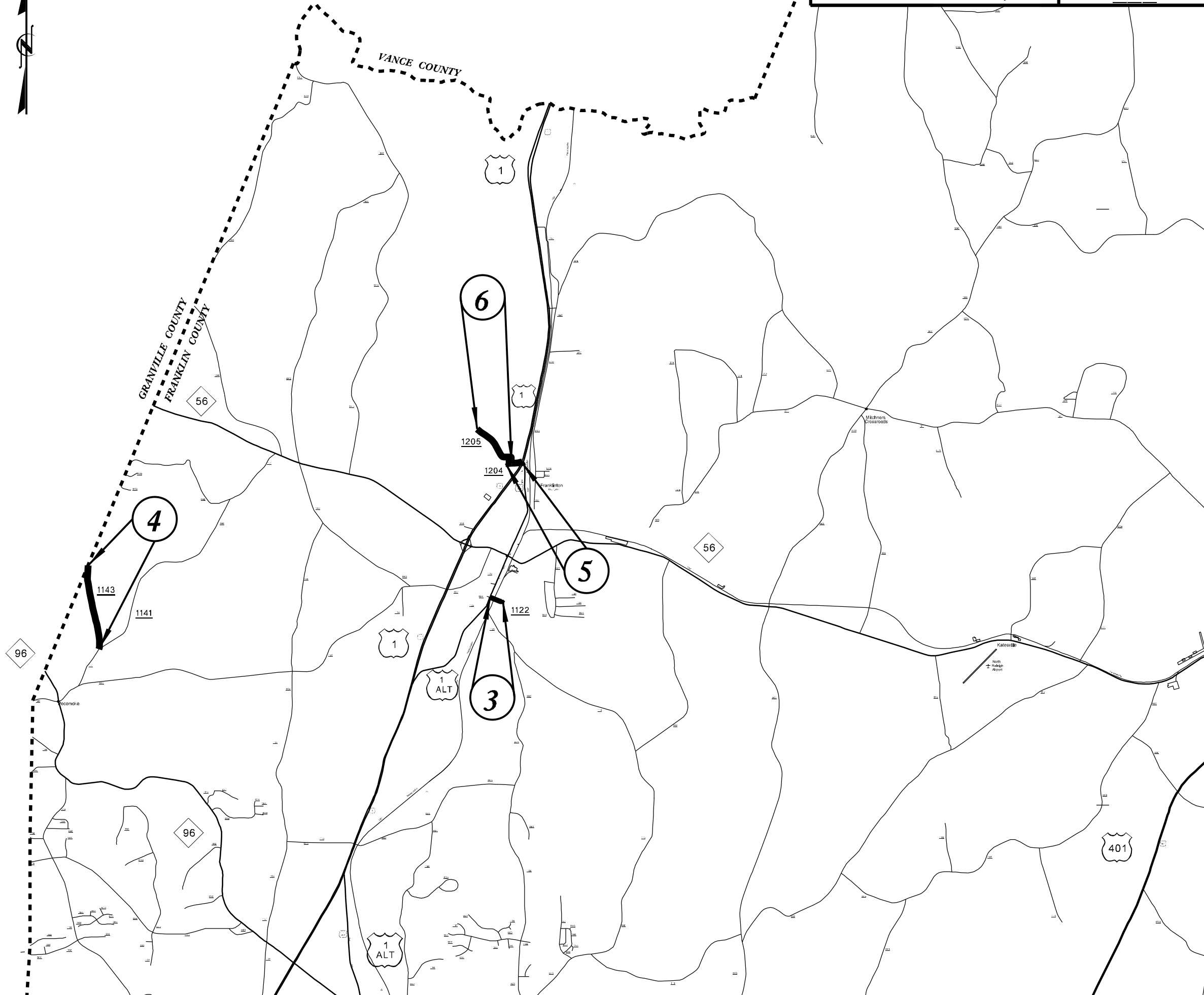

5/14/19  
C:\PROJECTS\2018-2019\2018-2019 FRANKLIN COUNTY CHIP SEAL\2018-2019 FRANKLIN COUNTY CHIP SEAL.DWG



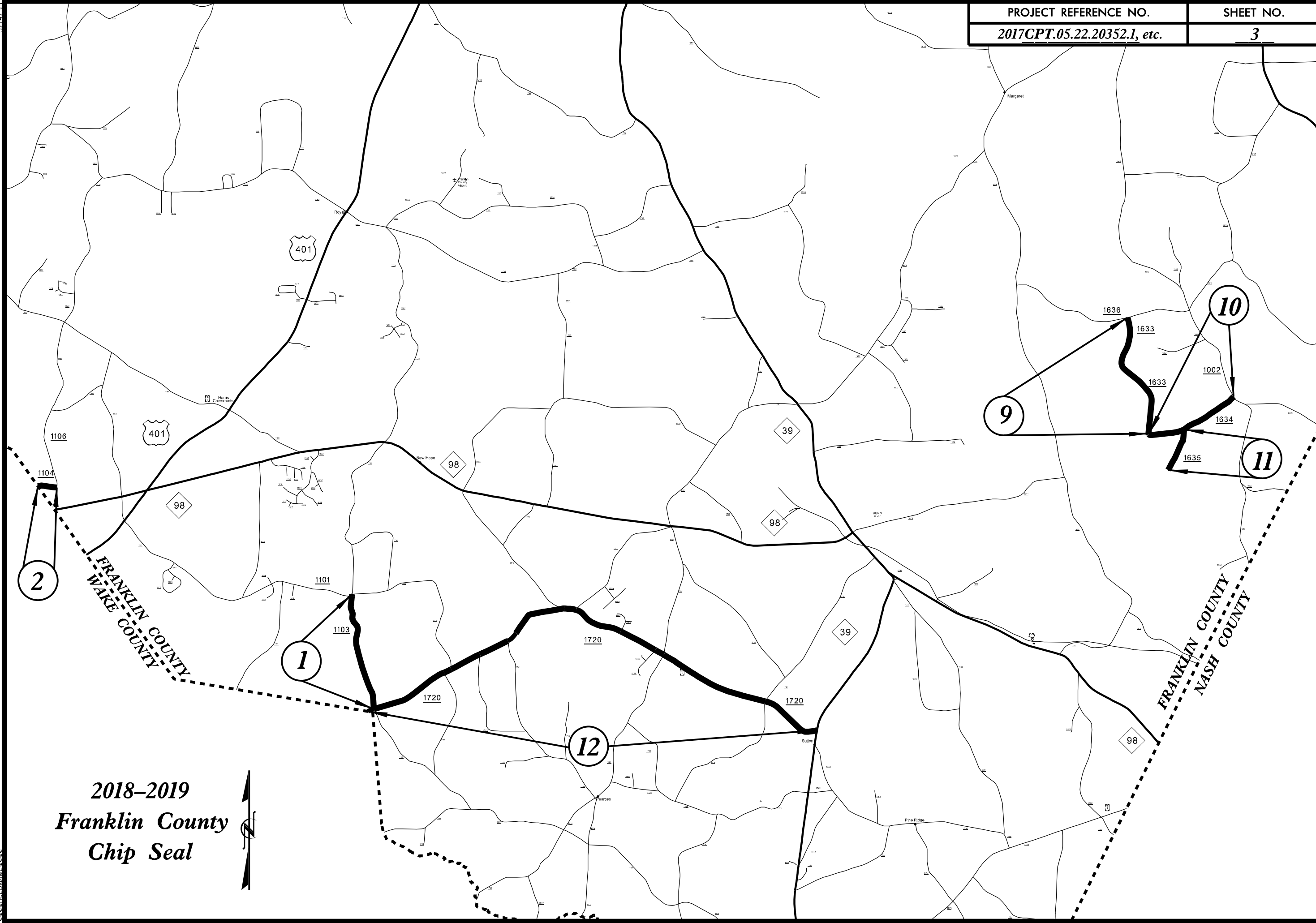

2018-2019  
Franklin County  
Chip Seal



5/14/19  
D:\Projects\2018-2019\Franklin\_County\_Chip\_Seal\Map\_Series\Map\_Series.dwg

2017-2018  
Granville County  
Chip Seal

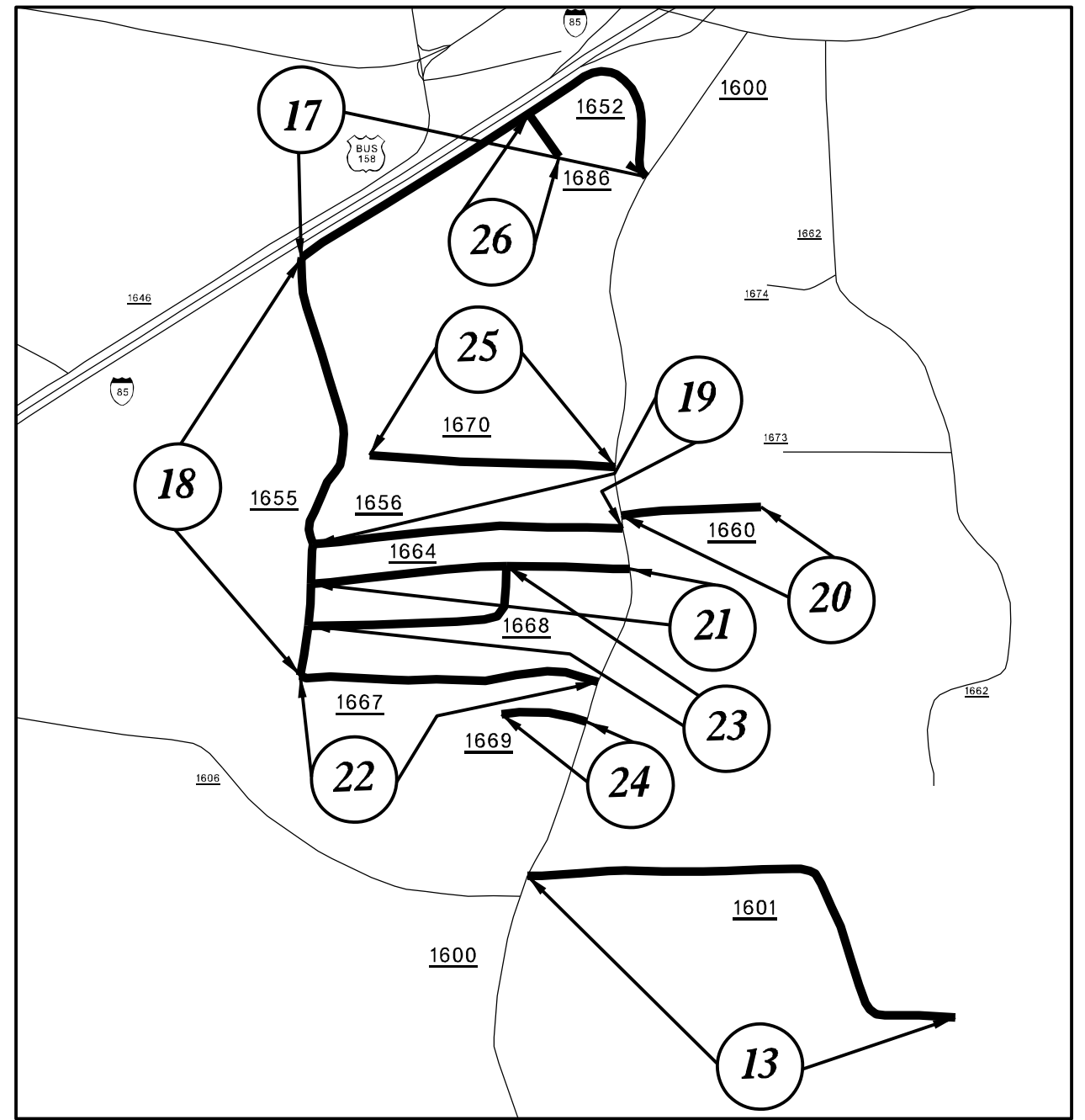
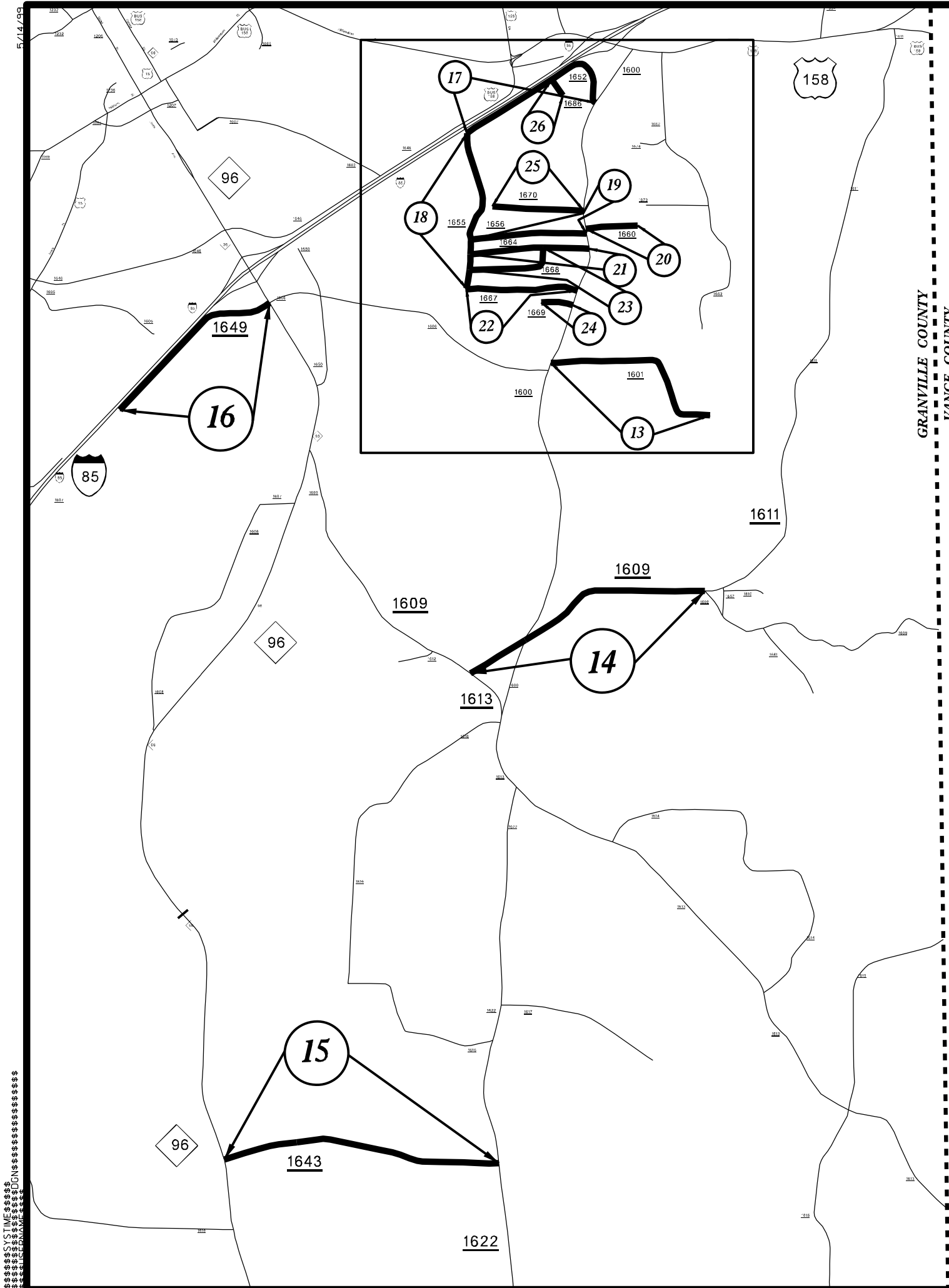

GRANVILLE COUNTY  
 VANCE COUNTY  
 5/14/19

2017-2018  
Vance County  
Chip Seal



GRANVILLE COUNTY  
VANCE COUNTY

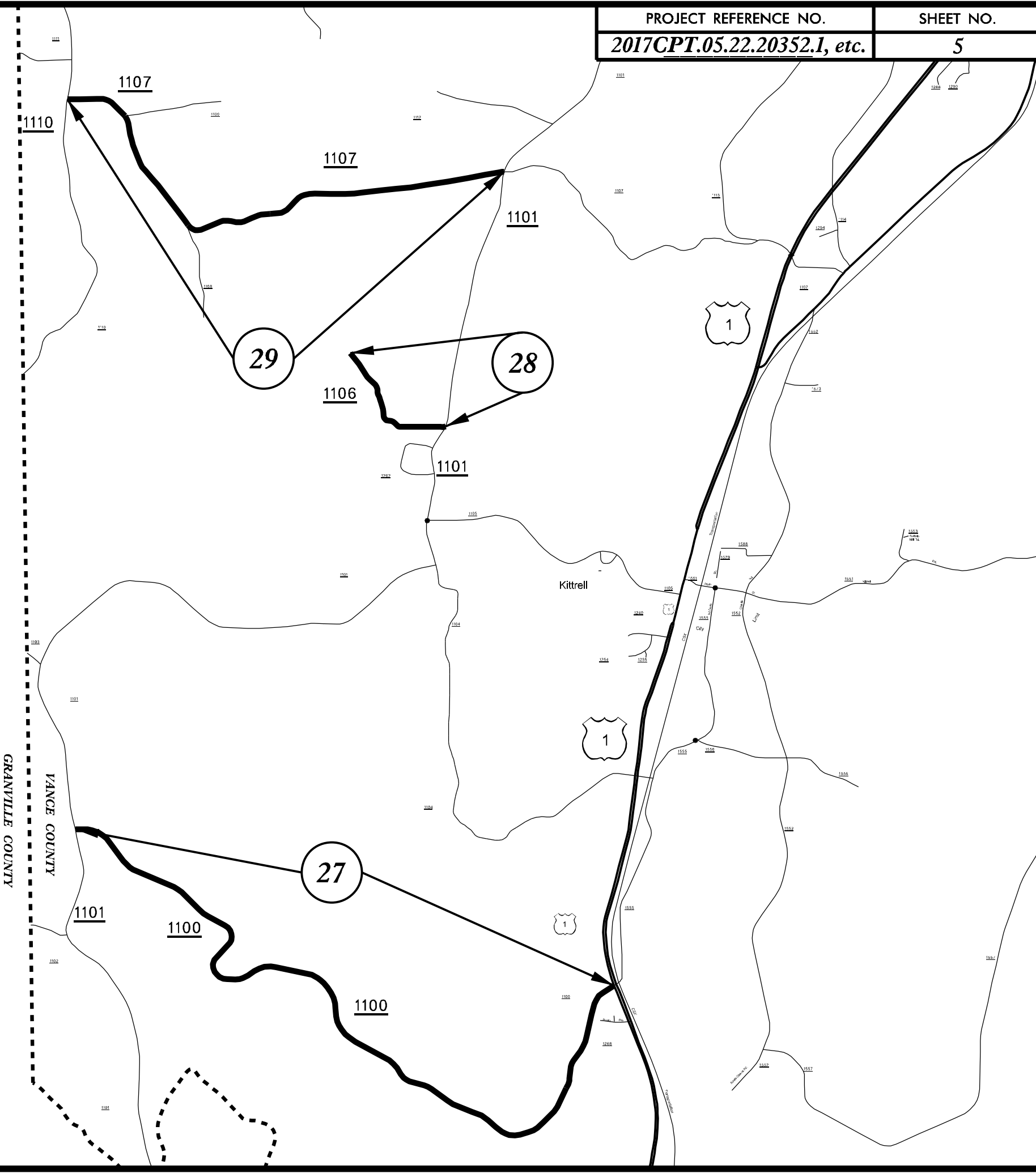

5/14/95  
C:\PROJECTS\2017-2018\2017CPT.05.22.20352.1\2017CPT.05.22.20352.1.dwg



**2018–2019  
Warren County  
Chip Seal**

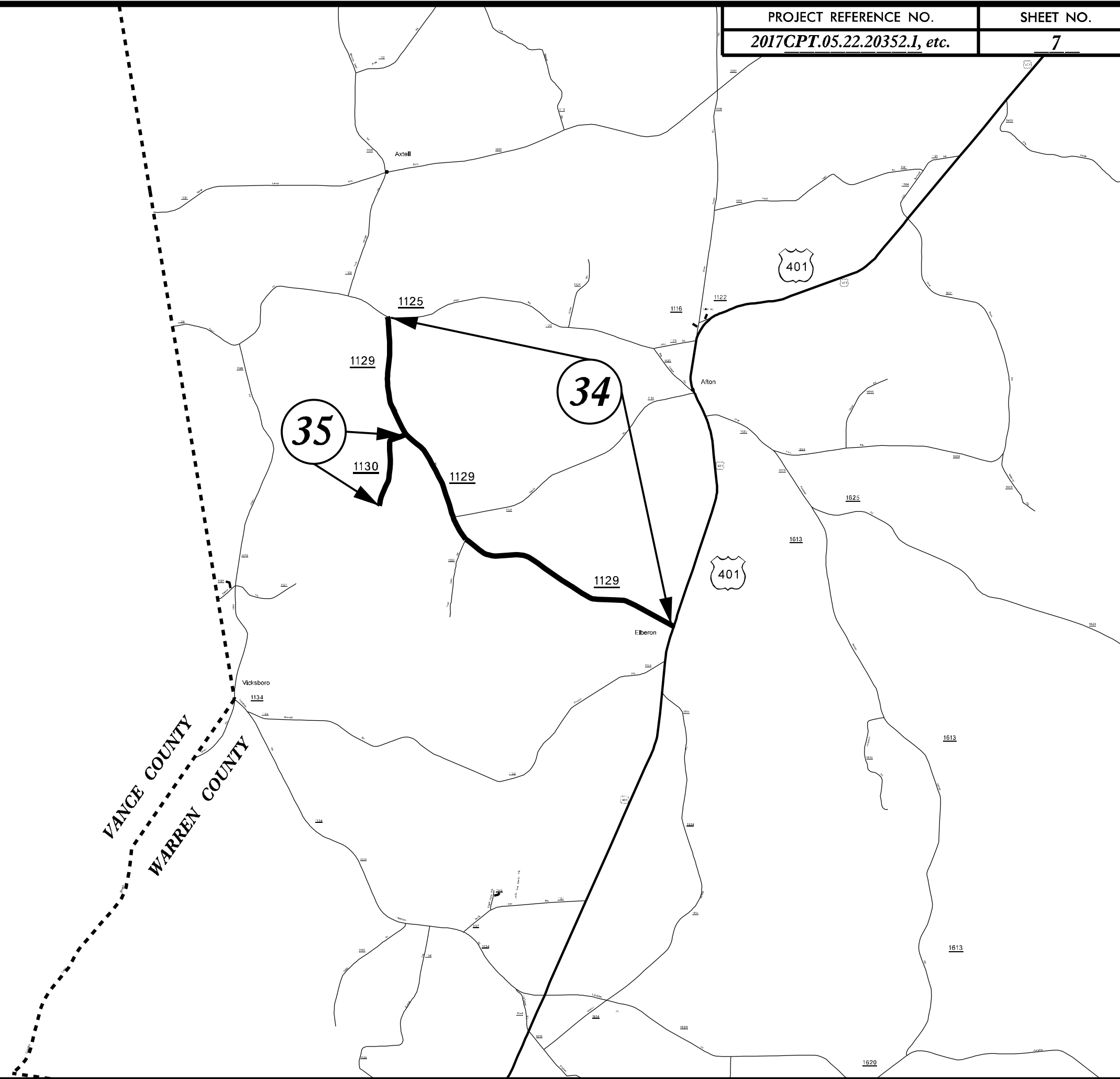

VANCE COUNTY  
WARREN COUNTY

5/14/19  
 \$\$\$\$\$\$ CURTIVE \$\$\$\$\$\$  
 \$\$\$\$\$\$ 2018-2019 \$\$\$\$\$\$  
 \$\$\$\$\$\$ WARREN COUNTY \$\$\$\$\$\$  
 \$\$\$\$\$\$ CHIP SEAL \$\$\$\$\$\$  
 \$\$\$\$\$\$ \$\$\$\$\$\$ \$\$\$\$\$\$



# 2018-2019 Warren County Chip Seal

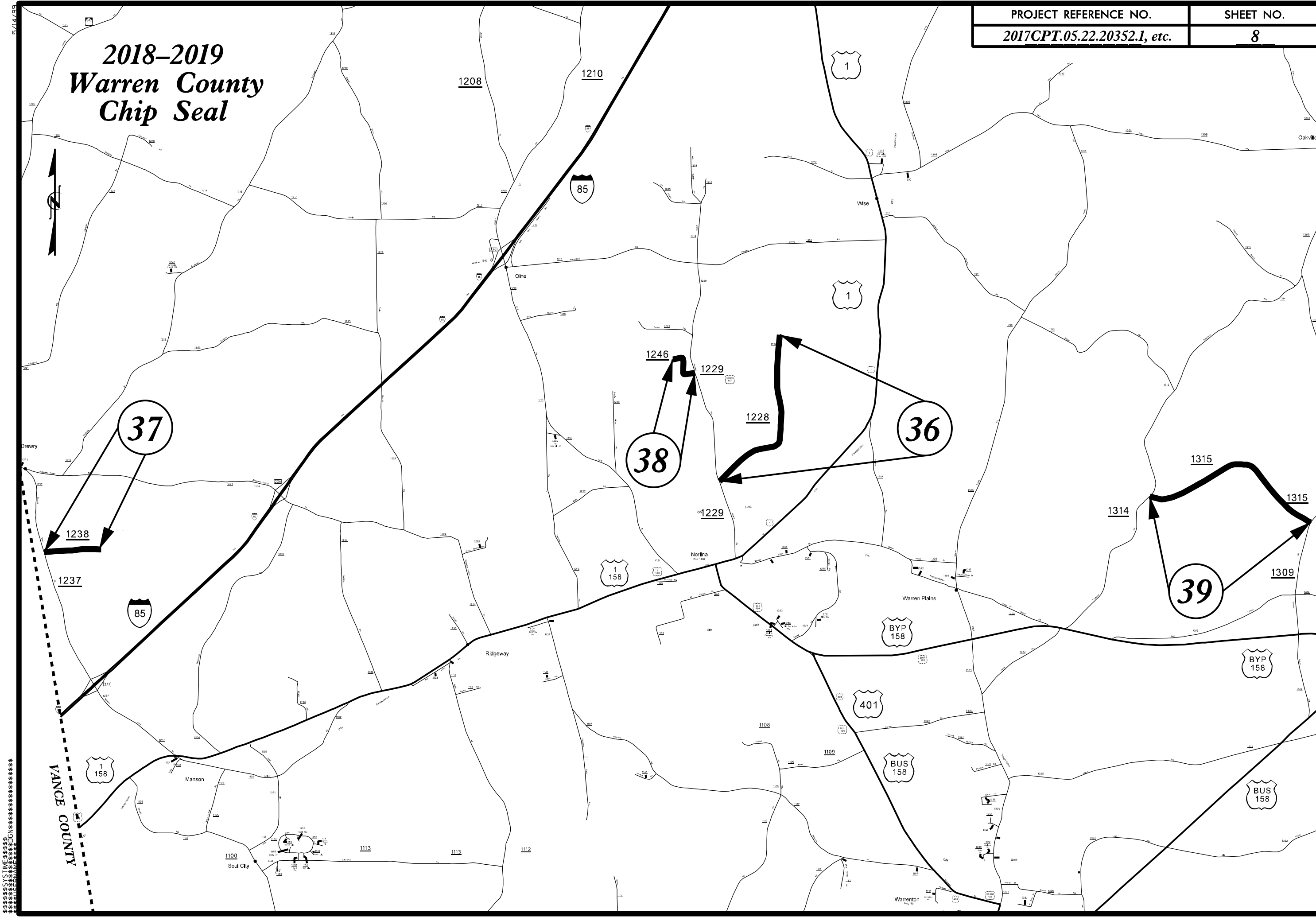

5/14/19  
C:\PROJECTS\2017CPT\2017CPT.05.22.20352.1\2017CPT.05.22.20352.1\_8.dwg

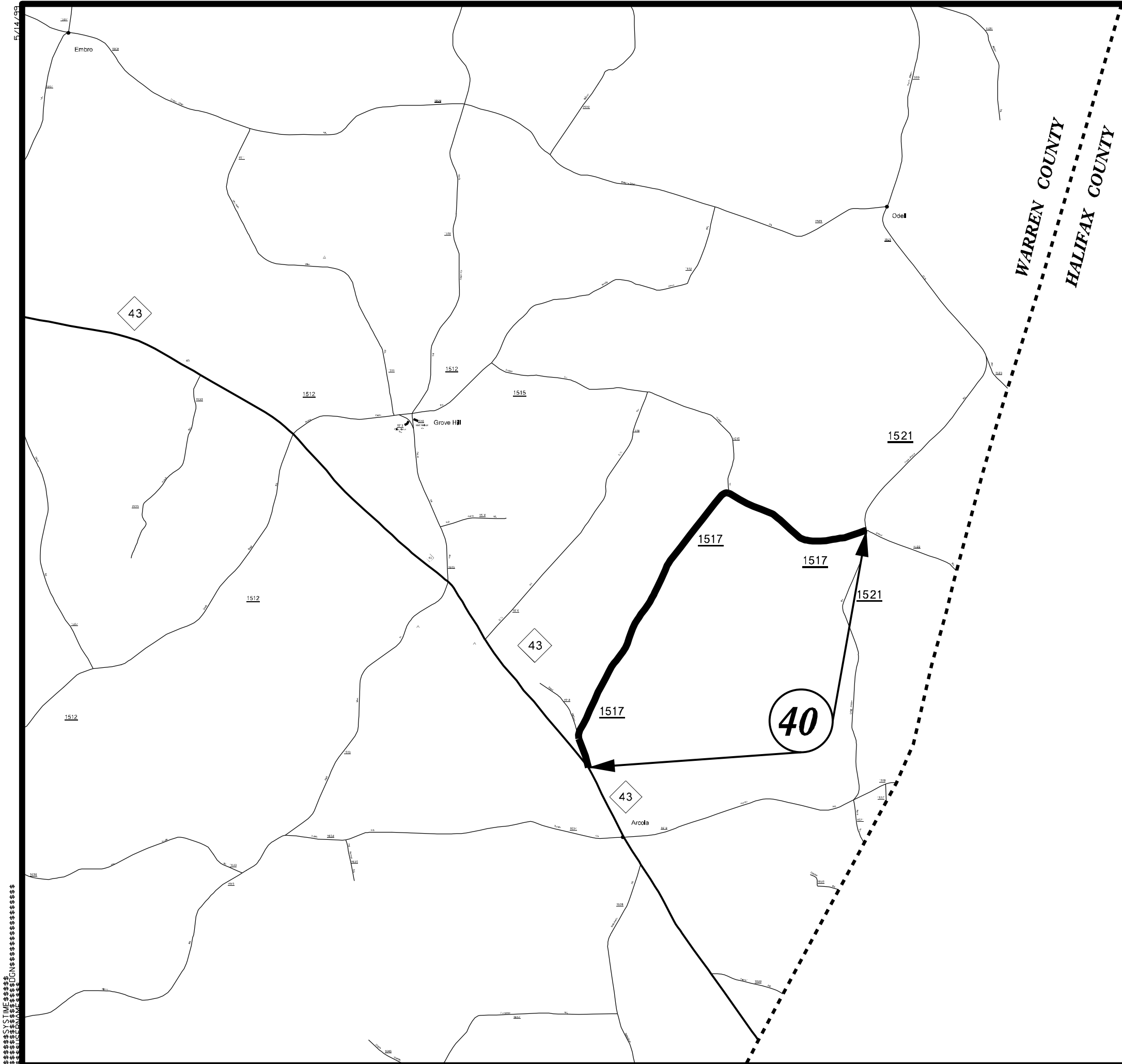

**2018–2019  
Warren County  
Chip Seal**



5/14/19  
C:\TIF\4352.DWG

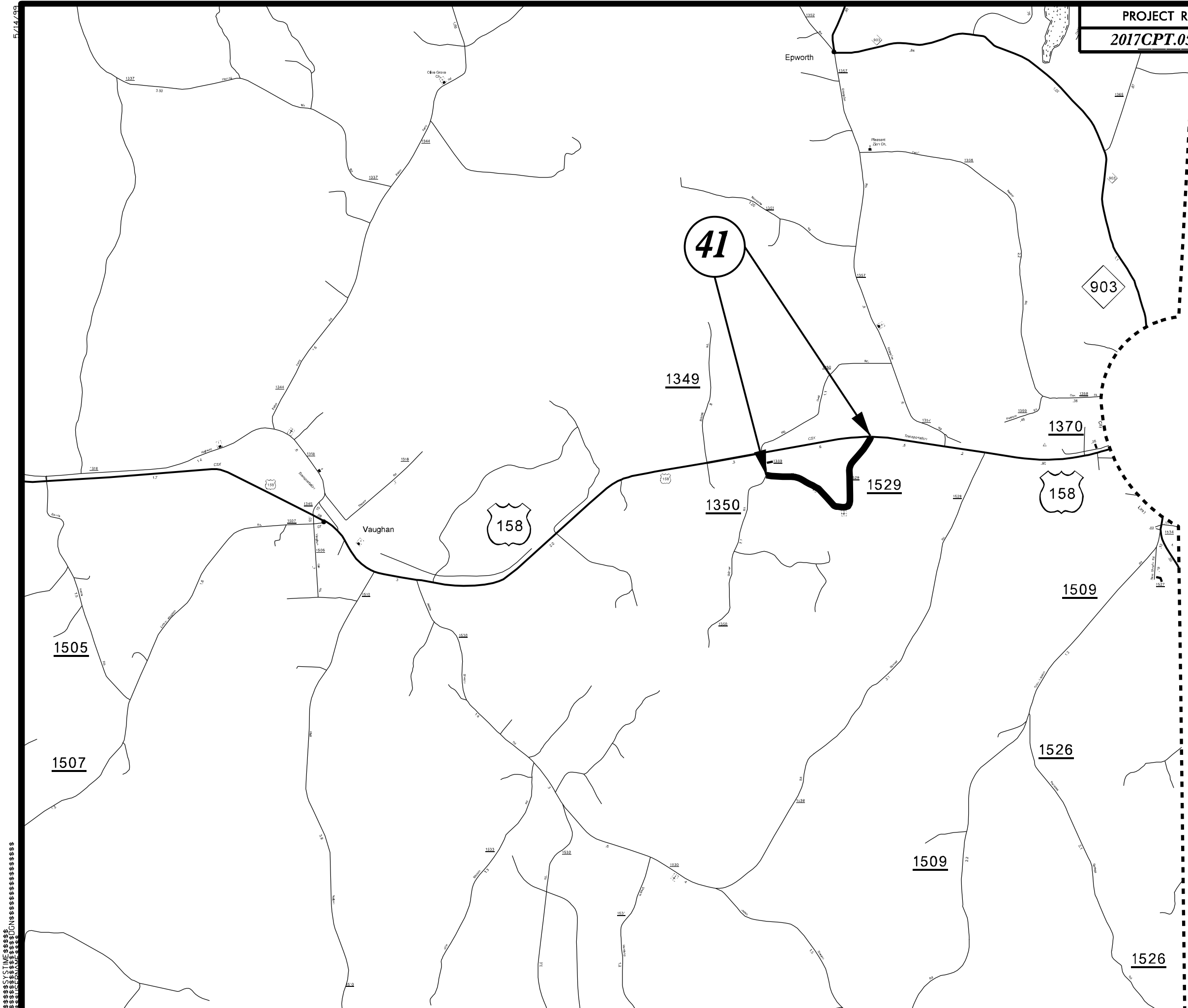

HALIFAX COUNTY

**2018-2019  
Warren County  
Chip Seal**

5/14/19  
C:\PROJECTS\2018-2019 WARREN COUNTY CHIP SEAL\MAPS\MAP 10.DWG

PAVEMENT SCHEDULE

PROJECT REFERENCE NO.

SHEET NO.

2017CPT.05.22.20352.1, etc.

11

F1	PROP. ASPHALT SURFACE TREATMENT, DOUBLE SEAL
F2	PROP. ASPHALT SURFACE TREATMENT, TRIPLE SEAL
S	SHOULDER GRADING, ASB REQUIRED (EXCEPT AT RESIDENTIAL AREAS)
U	EXISTING PAVEMENT
U2	EXISTING ABC TO BE CONDITIONED AND SHAPED

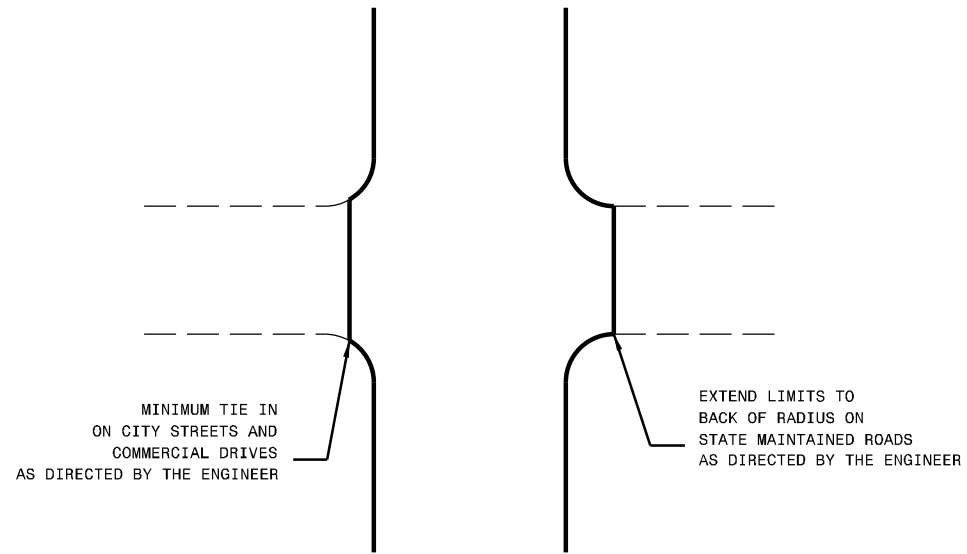

DETAIL OF PROJECT LIMITS AT Y LINES

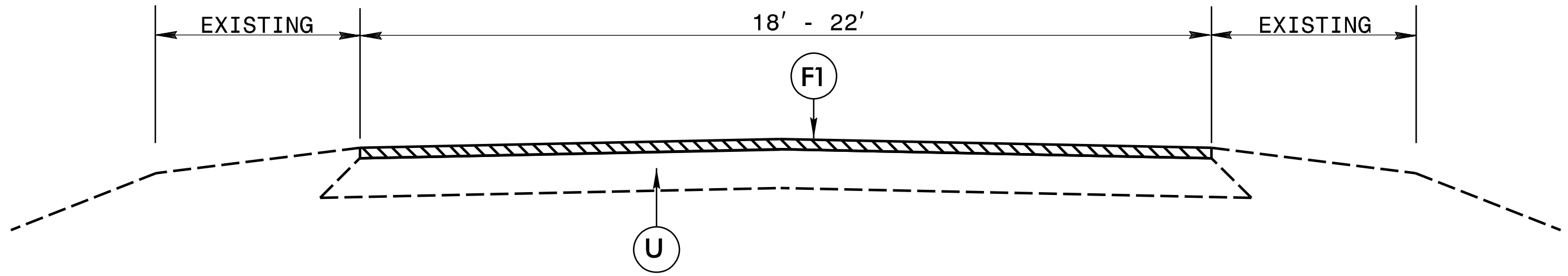

TYPICAL SECTION 1

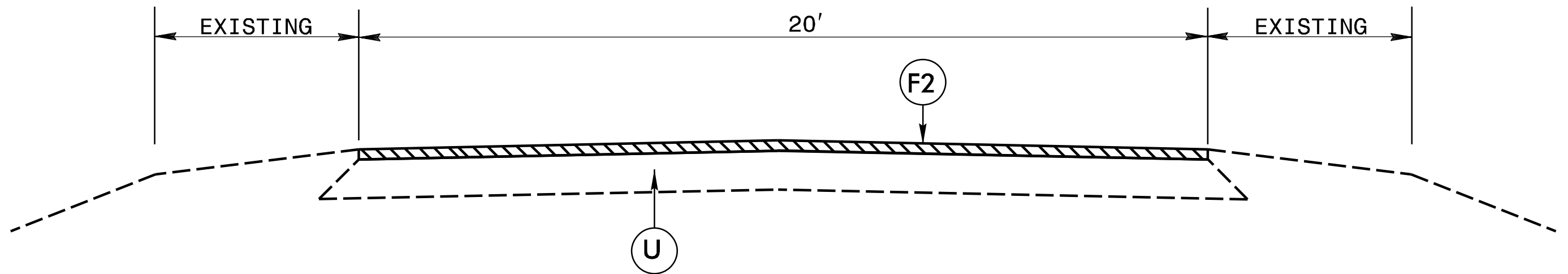

TYPICAL SECTION 2

PAVEMENT SCHEDULE

PROJECT REFERENCE NO.  
2017CPT.05.22.20352.1, etc.

SHEET NO.  
12

F1	PROP. ASPHALT SURFACE TREATMENT, DOUBLE SEAL
F2	PROP. ASPHALT SURFACE TREATMENT, TRIPLE SEAL
S	SHOULDER GRADING, ASB REQUIRED (EXCEPT AT RESIDENTIAL AREAS)
U	EXISTING PAVEMENT
U2	EXISTING ABC TO BE CONDITIONED AND SHAPED

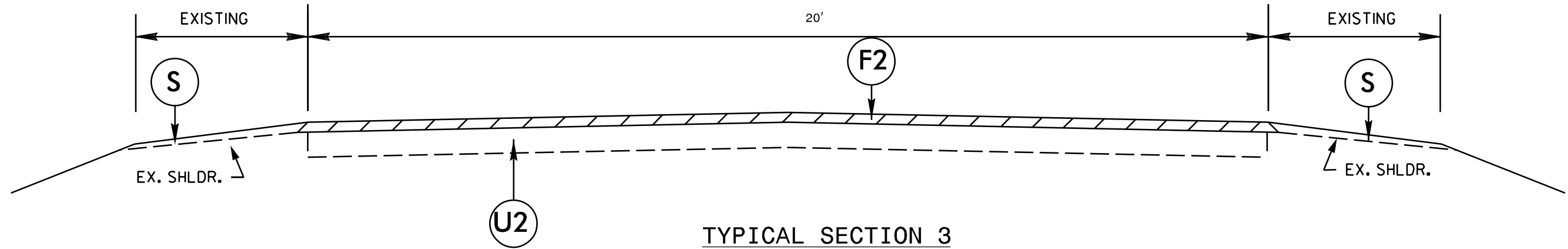

PROJECT NO.	SHEET NO.	TOTAL NO.
2017CPT.05.22.20352.1, etc.		

## SUMMARY OF QUANTITIES

PROJECT NO	COUNTY	MAP NO	ROUTE	DESCRIPTION	TYP	LANES	LANE TYPE	FINAL SURFACE TESTING REQUIRED	WARM MIX ASPHALT REQUIRED	LENGTH MI	WIDTH FT	AGGREGATE SHOULDER BORROW (ASB) TON	REPAIR EXISTING AGGREGATE BASE COURSE TON	SHOULDER GRADING SMI	CONDITIONING EXISTING BASE MSY	ASPHALT SURFACE TREATMENT, DOUBLE SEAL SY	ASPHALT SURFACE TREATMENT, TRIPLE SEAL SY	EMULSION FOR ASPHALT SURFACE TREATMENT GAL
2017CPT.05.22.20352.1	Franklin	1	SR 1103 - BETHLEHEM CHURCH RD	SR 1720 - OLD HALIFAX RD TO SR 1715 - BOB RICHARDS RD	1	2		NO	NO	1.39	18					14,678		8,073
<b>TOTAL FOR MAP NO. 1</b>										<b>1.39</b>						<b>14,678</b>		<b>8,073</b>
2017CPT.05.22.20352.1	Franklin	2	SR 1104 - SATTERWHITE RD	SR 1106 - MOORES POND RD TO WAKE CO	1	2		NO	NO	0.21	20					2,464		1,355
<b>TOTAL FOR MAP NO. 2</b>										<b>0.21</b>						<b>2,464</b>		<b>1,355</b>
2017CPT.05.22.20352.1	Franklin	3	SR 1122 - HAWKINS ST	US 1 ALT - TO 740 FEET EAST OF US 1 ALT (SKIP RAILROAD)	1	2		NO	NO	0.14	20					1,643		904
<b>TOTAL FOR MAP NO. 3</b>										<b>0.14</b>						<b>1,643</b>		<b>904</b>
2017CPT.05.22.20352.1	Franklin	4	SR 1143 - SUITT RD	SR- 1141 - GORDON MOORE RD TO GRANVILLE CO	2	2		NO	NO	0.85	20						9,973	7,978
<b>TOTAL FOR MAP NO. 4</b>										<b>0.85</b>							<b>9,973</b>	<b>7,978</b>
2017CPT.05.22.20352.1	Franklin	5	SR 1204 - MANN ST	US 1 - TO END OF PAVEMENT	1	2		NO	NO	0.14	18					1,478		813
<b>TOTAL FOR MAP NO. 5</b>										<b>0.14</b>						<b>1,478</b>		<b>813</b>
2017CPT.05.22.20352.1	Franklin	6	SR 1205 - R. D. COLLINS RD	SR 1204 - MANN ST TO CUL-DE-SAC	1	2		NO	NO	0.54	18					5,702		3,136
<b>TOTAL FOR MAP NO. 6</b>										<b>0.54</b>						<b>5,702</b>		<b>3,136</b>
2017CPT.05.22.20352.1	Franklin	7	SR 1467 - FISHING ROCK RD	SR 1425 - WHITE LEVEL RD TO NC 56	1	2		NO	NO	2.82	20					33,088		18,198
<b>TOTAL FOR MAP NO. 7</b>										<b>2.82</b>						<b>33,088</b>		<b>18,198</b>
2017CPT.05.22.20352.1	Franklin	8	SR 1604 - EGYPT CHURCH RD	NC 39 - TO END OF PAVEMENT	1	2		NO	NO	1.34	20					15,723		8,648
<b>TOTAL FOR MAP NO. 8</b>										<b>1.34</b>						<b>15,723</b>		<b>8,648</b>
2017CPT.05.22.20352.1	Franklin	9	SR 1633 - JOHN MANN RD	SR 1636 - SYKES RD TO SR 1634 - MOORE PERKERSON RD	1	2		NO	NO	1.51	20					17,717		9,744
<b>TOTAL FOR MAP NO. 9</b>										<b>1.51</b>						<b>17,717</b>		<b>9,744</b>
2017CPT.05.22.20352.1	Franklin	10	SR 1634 - MOORE PERKERSON RD	SR 1002 - SEVEN PATHS RD TO SR 1633 - JOHN MANN RD	1	2		NO	NO	1.11	20					13,024		7,163
<b>TOTAL FOR MAP NO. 10</b>										<b>1.11</b>						<b>13,024</b>		<b>7,163</b>
2017CPT.05.22.20352.1	Franklin	11	SR 1635 - C.P. SYKES RD	SR 1634 - MOORE PERKERSON RD TO CUL-DE-SAC	1	2		NO	NO	0.51	20					5,984		3,291
<b>TOTAL FOR MAP NO. 11</b>										<b>0.51</b>						<b>5,984</b>		<b>3,291</b>
2017CPT.05.22.20352.1	Franklin	12	SR 1720 - BRANTLEYTOWN RD/OLD HALIFAX RD	NC 39 - TO WAKE CO	1	2		NO	NO	5.96	19					66,434		36,539
<b>TOTAL FOR MAP NO. 12</b>										<b>5.96</b>						<b>66,434</b>		<b>36,539</b>
<b>TOTAL FOR PROJ NO. 2017CPT.05.22.20352.1</b>										<b>16.52</b>						<b>177,935</b>	<b>9,973</b>	<b>105,842</b>
2017CPT.05.22.20392.1	Granville	13	SR 1601 - ROCK BROOK RD	SR 1600 - ANTIOCH RD TO DEAD END	1	2		NO	NO	1.09	18					11,510		6,331
<b>TOTAL FOR MAP NO. 13</b>										<b>1.09</b>						<b>11,510</b>		<b>6,331</b>
2017CPT.05.22.20392.1	Granville	14	SR 1609 - ED HARRIS RD	SR 1613 - FAIRPORT RD TO SR 1611 - DORSEY RD	1	2		NO	NO	1.49	18					15,734		8,654
<b>TOTAL FOR MAP NO. 14</b>										<b>1.49</b>						<b>15,734</b>		<b>8,654</b>
2017CPT.05.22.20392.1	Granville	15	SR 1643 - EATON RD	SR 1622 - CANNADY MILL RD TO NC 96	1	2		NO	NO	1.56	20					18,304		10,067
<b>TOTAL FOR MAP NO. 15</b>										<b>1.56</b>						<b>18,304</b>		<b>10,067</b>
2017CPT.05.22.20392.1	Granville	16	SR 1649 - NEW COMMERCE RD	NC 96 - M.L.K. JR AVE TO DEAD END	1	2		NO	NO	1.07	20					12,555		6,905
<b>TOTAL FOR MAP NO. 16</b>										<b>1.07</b>						<b>12,555</b>		<b>6,905</b>
2017CPT.05.22.20392.1	Granville	17	SR 1652 - TABBS CREEK CHURCH RD	SR 1600 - ANTIOCH RD TO SR 1655 - FOREST VIEW HGTS	1	2		NO	NO	1.02	20					11,968		6,582
<b>TOTAL FOR MAP NO. 17</b>										<b>1.02</b>						<b>11,968</b>		<b>6,582</b>
2017CPT.05.22.20392.1	Granville	18	SR 1655 - FOREST VIEW HGTS	SR 1652 - TABBS CREEK CHURCH RD TO SR 1667 - RICHARD LN	1	2		NO	NO	0.93	20					10,912		6,002
<b>TOTAL FOR MAP NO. 18</b>										<b>0.93</b>						<b>10,912</b>		<b>6,002</b>
2017CPT.05.22.20392.1	Granville	19	SR 1656 - DOOSTER ST	SR 1600 - ANTIOCH RD TO SR 1655 - FOREST VIEW HGTS	1	2		NO	NO	0.66	20					7,744		4,259
<b>TOTAL FOR MAP NO. 19</b>										<b>0.66</b>						<b>7,744</b>		<b>4,259</b>
2017CPT.05.22.20392.1	Granville	20	SR 1660 - CHARLIE HARRIS RD	SR 1600 - ANTIOCH RD TO DEAD END	1	2		NO	NO	0.29	20					3,403		1,872
<b>TOTAL FOR MAP NO. 20</b>										<b>0.29</b>						<b>3,403</b>		<b>1,872</b>
2017CPT.05.22.20392.1	Granville	21	SR 1664 - LYN ST	SR 1600 - ANTIOCH RD TO SR 1655 - FOREST VIEW HGTS	1	2		NO	NO	0.68	20					7,979		4,388
<b>TOTAL FOR MAP NO. 21</b>										<b>0.68</b>						<b>7,979</b>		<b>4,388</b>
2017CPT.05.22.20392.1	Granville	22	SR 1667 - RICHARD LN	SR 1600 - ANTIOCH RD TO SR 1655 - FOREST VIEW HGTS	1	2		NO	NO	0.63	20					7,392		4,066
<b>TOTAL FOR MAP NO. 22</b>										<b>0.63</b>						<b>7,392</b>		<b>4,066</b>

PROJECT NO.	SHEET NO.	TOTAL NO.
2017CPT.05.22.20352.1, etc.		

## SUMMARY OF QUANTITIES

PROJECT NO	COUNTY	MAP NO	ROUTE	DESCRIPTION	TYP	LANES	LANE TYPE	FINAL SURFACE TESTING REQUIRED	WARM MIX ASPHALT REQUIRED	LENGTH MI	WIDTH FT	AGGREGATE SHOULDER BORROW (ASB) TON	REPAIR EXISTING AGGREGATE BASE COURSE TON	SHOULDER GRADING SMI	CONDITIONING EXISTING BASE MSY	ASPHALT SURFACE TREATMENT, DOUBLE SEAL SY	ASPHALT SURFACE TREATMENT, TRIPLE SEAL SY	EMULSION FOR ASPHALT SURFACE TREATMENT GAL
2017CPT.05.22.20392.1	Granville	23	SR 1668 - CRESTVIEW LN	SR 1664 - LYN ST TO SR 1655 - FOREST VIEW HGTS	1	2		NO	NO	0.52	20					6,101		3,356
<b>TOTAL FOR MAP NO. 23</b>										<b>0.52</b>						<b>6,101</b>		<b>3,356</b>
2017CPT.05.22.20392.1	Granville	24	SR 1669 - SHANNON DR	SR 1600 - ANTIOCH RD TO DEAD END	1	2		NO	NO	0.18	20					2,112		1,162
<b>TOTAL FOR MAP NO. 24</b>										<b>0.18</b>						<b>2,112</b>		<b>1,162</b>
2017CPT.05.22.20392.1	Granville	25	SR 1670 - PINE TREE HOLLOW DR	SR 1600 - ANTIOCH RD TO DEAD END	1	2		NO	NO	0.52	20					6,101		3,356
<b>TOTAL FOR MAP NO. 25</b>										<b>0.52</b>						<b>6,101</b>		<b>3,356</b>
2017CPT.05.22.20392.1	Granville	26	SR 1686 - COVE LN	SR 1652 - TABBS CR CH RD TO DEAD END	1	2		NO	NO	0.1	20					1,173		645
<b>TOTAL FOR MAP NO. 26</b>										<b>0.1</b>						<b>1,173</b>		<b>645</b>
<b>TOTAL FOR PROJ NO. 2017CPT.05.22.20392.1</b>										<b>10.74</b>						<b>122,988</b>		<b>67,645</b>
2017CPT.05.22.20912.1	Vance	27	SR 1100 - EGYPT MOUNTAIN RD	US 1 - TO SR 1101 - CHARLIE GRISSOM RD	1	2		NO	NO	4.45	20					52,213		28,717
<b>TOTAL FOR MAP NO. 27</b>										<b>4.45</b>						<b>52,213</b>		<b>28,717</b>
2017CPT.05.22.20912.1	Vance	28	SR 1106 - VAN DYKE RD	SR 1101 - S LYNNBANK RD TO CUL-DE-SAC	1	2		NO	NO	0.76	20					8,917		4,904
<b>TOTAL FOR MAP NO. 28</b>										<b>0.76</b>						<b>8,917</b>		<b>4,904</b>
2017CPT.05.22.20912.1	Vance	29	SR 1107 - COMMUNITY HOUSE RD	SR 1101 - N LYNNBANK RD TO SR 1110 - OLD WATKINS RD	1	2		NO	NO	2.84	19					31,657		17,411
<b>TOTAL FOR MAP NO. 29</b>										<b>2.84</b>						<b>31,657</b>		<b>17,411</b>
2017CPT.05.22.20912.1	Vance	30	SR 1130 - EVANS RD	SR 1128 - RUIN CREEK RD TO DEAD END	1	2		NO	NO	0.52	20					6,101		3,356
<b>TOTAL FOR MAP NO. 30</b>										<b>0.52</b>						<b>6,101</b>		<b>3,356</b>
2017CPT.05.22.20912.1	Vance	31	SR 1242 - TRUMAN AVE	US 158 BUS - TO DEAD END	1	2		NO	NO	0.42	18					4,435		2,439
<b>TOTAL FOR MAP NO. 31</b>										<b>0.42</b>						<b>4,435</b>		<b>2,439</b>
2017CPT.05.22.20912.1	Vance	32	SR 1410 - RED BUD BAPTIST CH RD	US 158 BUS - TO DEAD END	1	2		NO	NO	0.13	20					1,525		839
<b>TOTAL FOR MAP NO. 32</b>										<b>0.13</b>						<b>1,525</b>		<b>839</b>
2017CPT.05.22.20912.1	Vance	33	SR 1416 - WOODLAWN RD	SR 1410 - RED BUD BAPTIST CH RD TO SR 1128 - RUIN CREEK RD	1	2		NO	NO	0.24	22					3,098		1,704
<b>TOTAL FOR MAP NO. 33</b>										<b>0.24</b>						<b>3,098</b>		<b>1,704</b>
<b>TOTAL FOR PROJ NO. 2017CPT.05.22.20912.1</b>										<b>9.36</b>						<b>107,946</b>		<b>59,370</b>
2017CPT.05.22.20932.1	Warren	34	SR 1129 - LARGO RD/LARGO LAKE	US 401 - TO SR 1125 - TOWER RD	1	2		NO	NO	3.5	20					41,067		22,587
<b>TOTAL FOR MAP NO. 34</b>										<b>3.5</b>						<b>41,067</b>		<b>22,587</b>
2017CPT.05.22.20932.1	Warren	35	SR 1130 - PREACHER WILSON RD	SR 1129 - LARGO RD TO END MAINT	1	2		NO	NO	0.63	18					6,653		3,659
<b>TOTAL FOR MAP NO. 35</b>										<b>0.63</b>						<b>6,653</b>		<b>3,659</b>
2017CPT.05.22.20932.1	Warren	36	SR 1228 - HAWKS RD	SR 1229 - HEAVEN ST TO END OF PAVEMENT	1	2		NO	NO	1.59	20					18,656		10,261
<b>TOTAL FOR MAP NO. 36</b>										<b>1.59</b>						<b>18,656</b>		<b>10,261</b>
2017CPT.05.22.20932.1	Warren	37	SR 1238 - WELDON CAPPAS RD	SR 1237 - MANSON-DREWRY RD TO CUL-DE-SAC	1	2		NO	NO	0.49	20					5,749		3,162
<b>TOTAL FOR MAP NO. 37</b>										<b>0.49</b>						<b>5,749</b>		<b>3,162</b>
2017CPT.05.22.20932.1	Warren	38	SR 1246 - LEROY GREEN RD	SR 1229 - HEAVEN ST TO END MAINT	1	2		NO	NO	0.32	18					3,379		1,858
<b>TOTAL FOR MAP NO. 38</b>										<b>0.32</b>						<b>3,379</b>		<b>1,858</b>
2017CPT.05.22.20932.1	Warren	39	SR 1315 - PETER STALLINGS RD	SR 1314 - WAVIELY THOMPSON RD TO SR 1309 - OAKVILLE RD	1	2		NO	NO	1.66	20					19,477		10,712
<b>TOTAL FOR MAP NO. 39</b>										<b>1.66</b>						<b>19,477</b>		<b>10,712</b>
2017CPT.05.22.20932.1	Warren	40	SR 1517 - LONG SCHOOL RD	SR 1521 - RUDD TRAIL TO NC 43	1	2		NO	NO	3.51	20					41,184		22,651
<b>TOTAL FOR MAP NO. 40</b>										<b>3.51</b>						<b>41,184</b>		<b>22,651</b>
<b>TOTAL FOR PROJ NO. 2017CPT.05.22.20932.1</b>										<b>11.7</b>						<b>136,165</b>		<b>74,890</b>
5C.093050	Warren	41	SR 1529 - BIG REID RD	US 158 TO SR 1350 - JOHN SKINNER RD	3	2		NO	NO	0.99	20	190	15	1.98	12		11,616	9,293
<b>TOTAL FOR MAP NO. 41</b>										<b>0.99</b>		<b>190</b>	<b>15</b>	<b>1.98</b>	<b>12</b>		<b>11,616</b>	<b>9,293</b>
<b>TOTAL FOR PROJ NO. 5C.093050</b>										<b>0.99</b>		<b>190</b>	<b>15</b>	<b>1.98</b>	<b>12</b>		<b>11,616</b>	<b>9,293</b>
<b>GRAND TOTAL</b>										<b>49.31</b>		<b>190</b>	<b>15</b>	<b>1.98</b>	<b>12</b>	<b>545,034</b>	<b>21,589</b>	<b>317,040</b>

PROJECT NO.	SHEET NO.	TOTAL NO.
2017CPT.05.22.20352.1, etc.		

## THERMOPLASTIC AND PAINT QUANTITIES

PROJECT NO	COUNTY	MAP NO	ROUTE	DESCRIPTION	TYP	LANES	LANE TYPE	LENGTH	WIDTH	4413000000-E	4457000000-N	4705000000-E	4710000000-E	4721000000-E	4890000000-E
										WORK ZONE ADVANCE/ GENERAL WARNING SIGNING	TEMPORARY TRAFFIC CONTROL	16" X 120 M WHITE THERMO	24" X 120 M WHITE THERMO	THERMO RXR 120 M	HOT SPRAY THERMOPLASTIC PAVEMENT MARKING LINES, 4", 40 MIL
										SF	LS	LF	LF	EA	LF
2017CPT.05.22.20352.1	Franklin	1	SR 1103 - BETHLEHEM CHURCH RD	SR 1720 - OLD HALIFAX RD TO SR 1715 - BOB RICHARDS RD	1	2		1.39	18	156	0.03				29,420
			<b>TOTAL FOR MAP NO. 1</b>					<b>1.39</b>		<b>156</b>	<b>0.03</b>				<b>29,420</b>
2017CPT.05.22.20352.1	Franklin	2	SR 1104 - SATTERWHITE RD	SR 1106 - MOORES POND RD TO WAKE CO	1	2		0.21	20	24	0.01				
			<b>TOTAL FOR MAP NO. 2</b>					<b>0.21</b>		<b>24</b>	<b>0.01</b>				
2017CPT.05.22.20352.1	Franklin	3	SR 1122 - HAWKINS ST	US 1 ALT - TO 740 FEET EAST OF US 1 ALT (SKIP RAILROAD)	1	2		0.14	20	16	0.01	100	70	4	
			<b>TOTAL FOR MAP NO. 3</b>					<b>0.14</b>		<b>16</b>	<b>0.01</b>	<b>100</b>	<b>70</b>	<b>4</b>	
2017CPT.05.22.20352.1	Franklin	4	SR 1143 - SUITT RD	SR- 1141 - GORDON MOORE RD TO GRANVILLE CO	2	2		0.85	20	96	0.02				18,036
			<b>TOTAL FOR MAP NO. 4</b>					<b>0.85</b>		<b>96</b>	<b>0.02</b>				<b>18,036</b>
2017CPT.05.22.20352.1	Franklin	5	SR 1204 - MANN ST	US 1 - TO END OF PAVEMENT	1	2		0.14	18	16	0.01				
			<b>TOTAL FOR MAP NO. 5</b>					<b>0.14</b>		<b>16</b>	<b>0.01</b>				
2017CPT.05.22.20352.1	Franklin	6	SR 1205 - R. D. COLLINS RD	SR 1204 - MANN ST TO CUL-DE-SAC	1	2		0.54	18	60	0.01				
			<b>TOTAL FOR MAP NO. 6</b>					<b>0.54</b>		<b>60</b>	<b>0.01</b>				
2017CPT.05.22.20352.1	Franklin	7	SR 1467 - FISHING ROCK RD	SR 1425 - WHITE LEVEL RD TO NC 56	1	2		2.82	20	316	0.06				56,580
			<b>TOTAL FOR MAP NO. 7</b>					<b>2.82</b>		<b>316</b>	<b>0.06</b>				<b>56,580</b>
2017CPT.05.22.20352.1	Franklin	8	SR 1604 - EGYPT CHURCH RD	NC 39 - TO END OF PAVEMENT	1	2		1.34	20	150	0.03				22,994
			<b>TOTAL FOR MAP NO. 8</b>					<b>1.34</b>		<b>150</b>	<b>0.03</b>				<b>22,994</b>
2017CPT.05.22.20352.1	Franklin	9	SR 1633 - JOHN MANN RD	SR 1636 - SYKES RD TO SR 1634 - MOORE PERKERSON RD	1	2		1.51	20	169	0.03				31,094
			<b>TOTAL FOR MAP NO. 9</b>					<b>1.51</b>		<b>169</b>	<b>0.03</b>				<b>31,094</b>
2017CPT.05.22.20352.1	Franklin	10	SR 1634 - MOORE PERKERSON RD	SR 1002 - SEVEN PATHS RD TO SR 1633 - JOHN MANN RD	1	2		1.11	20	124	0.02				23,443
			<b>TOTAL FOR MAP NO. 10</b>					<b>1.11</b>		<b>124</b>	<b>0.02</b>				<b>23,443</b>
2017CPT.05.22.20352.1	Franklin	11	SR 1635 - C.P. SYKES RD	SR 1634 - MOORE PERKERSON RD TO CUL-DE-SAC	1	2		0.51	20	57	0.01				
			<b>TOTAL FOR MAP NO. 11</b>					<b>0.51</b>		<b>57</b>	<b>0.01</b>				
2017CPT.05.22.20352.1	Franklin	12	SR 1720 - BRANTLEYTOWN RD/OLD HALIFAX RD	NC 39 - TO WAKE CO	1	2		5.96	19	668	0.11				118,028
			<b>TOTAL FOR MAP NO. 12</b>					<b>5.96</b>		<b>668</b>	<b>0.11</b>				<b>118,028</b>
			<b>TOTAL FOR PROJ NO. 2017CPT.05.22.20352.1</b>					<b>16.52</b>		<b>1,852</b>	<b>0.35</b>	<b>100</b>	<b>70</b>	<b>4</b>	<b>299,595</b>
2017CPT.05.22.20392.1	Granville	13	SR 1601 - ROCK BROOK RD	SR 1600 - ANTIOCH RD TO DEAD END	1	2		1.09	18	122	0.02				23,021
			<b>TOTAL FOR MAP NO. 13</b>					<b>1.09</b>		<b>122</b>	<b>0.02</b>				<b>23,021</b>
2017CPT.05.22.20392.1	Granville	14	SR 1609 - ED HARRIS RD	SR 1613 - FAIRPORT RD TO SR 1611 - DORSEY RD	1	2		1.49	18	166	0.03				27,443
			<b>TOTAL FOR MAP NO. 14</b>					<b>1.49</b>		<b>166</b>	<b>0.03</b>				<b>27,443</b>
2017CPT.05.22.20392.1	Granville	15	SR 1643 - EATON RD	SR 1622 - CANNADY MILL RD TO NC 96	1	2		1.56	20	175	0.03				29,710
			<b>TOTAL FOR MAP NO. 15</b>					<b>1.56</b>		<b>175</b>	<b>0.03</b>				<b>29,710</b>
2017CPT.05.22.20392.1	Granville	16	SR 1649 - NEW COMMERCE RD	NC 96 - M.L.K. JR AVE TO DEAD END	1	2		1.07	20	120	0.02				
			<b>TOTAL FOR MAP NO. 16</b>					<b>1.07</b>		<b>120</b>	<b>0.02</b>				
2017CPT.05.22.20392.1	Granville	17	SR 1652 - TABBS CREEK CHURCH RD	SR 1600 - ANTIOCH RD TO SR 1655 - FOREST VIEW HGTS	1	2		1.02	20	114	0.02				21,190
			<b>TOTAL FOR MAP NO. 17</b>					<b>1.02</b>		<b>114</b>	<b>0.02</b>				<b>21,190</b>
2017CPT.05.22.20392.1	Granville	18	SR 1655 - FOREST VIEW HGTS	SR 1652 - TABBS CREEK CHURCH RD TO SR 1667 - RICHARD LN	1	2		0.93	20	104	0.02				19,313
			<b>TOTAL FOR MAP NO. 18</b>					<b>0.93</b>		<b>104</b>	<b>0.02</b>				<b>19,313</b>
2017CPT.05.22.20392.1	Granville	19	SR 1656 - DOOSTER ST	SR 1600 - ANTIOCH RD TO SR 1655 - FOREST VIEW HGTS	1	2		0.66	20	73	0.01				12,123
			<b>TOTAL FOR MAP NO. 19</b>					<b>0.66</b>		<b>73</b>	<b>0.01</b>				<b>12,123</b>
2017CPT.05.22.20392.1	Granville	20	SR 1660 - CHARLIE HARRIS RD	SR 1600 - ANTIOCH RD TO DEAD END	1	2		0.29	20	33	0.01				6,188
			<b>TOTAL FOR MAP NO. 20</b>					<b>0.29</b>		<b>33</b>	<b>0.01</b>				<b>6,188</b>
2017CPT.05.22.20392.1	Granville	21	SR 1664 - LYN ST	SR 1600 - ANTIOCH RD TO SR 1655 - FOREST VIEW HGTS	1	2		0.68	20	77	0.01				14,446
			<b>TOTAL FOR MAP NO. 21</b>					<b>0.68</b>		<b>77</b>	<b>0.01</b>				<b>14,446</b>
2017CPT.05.22.20392.1	Granville	22	SR 1667 - RICHARD LN	SR 1600 - ANTIOCH RD TO SR 1655 - FOREST VIEW HGTS	1	2		0.63	20	70	0.01				13,284
			<b>TOTAL FOR MAP NO. 22</b>					<b>0.63</b>		<b>70</b>	<b>0.01</b>				<b>13,284</b>



PROJECT NO.	SHEET NO.	TOTAL NO.
2017CPT.05.22.20352.1, etc.		

## THERMOPLASTIC AND PAINT QUANTITIES

PROJECT NO	COUNTY	MAP NO	ROUTE	DESCRIPTION	TYP	LANES	LANE TYPE	LENGTH	WIDTH	4413000000-E	4457000000-N	4705000000-E	4710000000-E	4721000000-E	4890000000-E	
										WORK ZONE ADVANCE/ GENERAL WARNING SIGNING	TEMPORARY TRAFFIC CONTROL	16" X 120 M WHITE THERMO	24" X 120 M WHITE THERMO	THERMO RXR 120 M	HOT SPRAY THERMOPLASTIC PAVEMENT MARKING LINES, 4", 40 MIL	
										SF	LS	LF	LF	EA	LF	
2017CPT.05.22.20392.1	Granville	23	SR 1668 - CRESTVIEW LN	SR 1664 - LYN ST TO SR 1655 - FOREST VIEW HGTS	1	2		0.52	20	58	0.01				11,004	
<b>TOTAL FOR MAP NO. 23</b>										<b>58</b>	<b>0.01</b>				<b>11,004</b>	
2017CPT.05.22.20392.1	Granville	24	SR 1669 - SHANNON DR	SR 1600 - ANTIOCH RD TO DEAD END	1	2		0.18	20	20	0.01					
<b>TOTAL FOR MAP NO. 24</b>										<b>20</b>	<b>0.01</b>					
2017CPT.05.22.20392.1	Granville	25	SR 1670 - PINE TREE HOLLOW DR	SR 1600 - ANTIOCH RD TO DEAD END	1	2		0.52	20	58	0.01				5,460	
<b>TOTAL FOR MAP NO. 25</b>										<b>58</b>	<b>0.01</b>				<b>5,460</b>	
2017CPT.05.22.20392.1	Granville	26	SR 1686 - COVE LN	SR 1652 - TABBS CR CH RD TO DEAD END	1	2		0.1	20	11	0.01					
<b>TOTAL FOR MAP NO. 26</b>										<b>11</b>	<b>0.01</b>					
<b>TOTAL FOR PROJ NO. 2017CPT.05.22.20392.1</b>										<b>10.74</b>	<b>1.201</b>	<b>0.22</b>			<b>183,182</b>	
2017CPT.05.22.20912.1	Vance	27	SR 1100 - EGYPT MOUNTAIN RD	US 1 - TO SR 1101 - CHARLIE GRISSOM RD	1	2		4.45	20	498	0.09				93,878	
<b>TOTAL FOR MAP NO. 27</b>										<b>4.45</b>	<b>0.09</b>				<b>93,878</b>	
2017CPT.05.22.20912.1	Vance	28	SR 1106 - VAN DYKE RD	SR 1101 - S LYNNBANK RD TO CUL-DE-SAC	1	2		0.76	20	85	0.01					
<b>TOTAL FOR MAP NO. 28</b>										<b>0.76</b>	<b>0.01</b>					
2017CPT.05.22.20912.1	Vance	29	SR 1107 - COMMUNITY HOUSE RD	SR 1101 - N LYNNBANK RD TO SR 1110 - OLD WATKINS RD	1	2		2.84	19	318	0.06				57,002	
<b>TOTAL FOR MAP NO. 29</b>										<b>2.84</b>	<b>0.06</b>				<b>57,002</b>	
2017CPT.05.22.20912.1	Vance	30	SR 1130 - EVANS RD	SR 1128 - RUIN CREEK RD TO DEAD END	1	2		0.52	20	58	0.01				1,040	
<b>TOTAL FOR MAP NO. 30</b>										<b>0.52</b>	<b>0.01</b>				<b>1,040</b>	
2017CPT.05.22.20912.1	Vance	31	SR 1242 - TRUMAN AVE	US 158 BUS - TO DEAD END	1	2		0.42	18	47	0.01					
<b>TOTAL FOR MAP NO. 31</b>										<b>0.42</b>	<b>0.01</b>					
2017CPT.05.22.20912.1	Vance	32	SR 1410 - RED BUD BAPTIST CH RD	US 158 BUS - TO DEAD END	1	2		0.13	20	14	0.01					
<b>TOTAL FOR MAP NO. 32</b>										<b>0.13</b>	<b>0.01</b>					
2017CPT.05.22.20912.1	Vance	33	SR 1416 - WOODLAWN RD	SR 1410 - RED BUD BAPTIST CH RD TO SR 1128 - RUIN CREEK RD	1	2		0.24	22	27	0.01				5,048	
<b>TOTAL FOR MAP NO. 33</b>										<b>0.24</b>	<b>0.01</b>				<b>5,048</b>	
<b>TOTAL FOR PROJ NO. 2017CPT.05.22.20912.1</b>										<b>9.36</b>	<b>1.047</b>	<b>0.20</b>			<b>156,968</b>	
2017CPT.05.22.20932.1	Warren	34	SR 1129 - LARGO RD/LARGO LAKE	US 401 - TO SR 1125 - TOWER RD	1	2		3.5	20	392	0.07				72,996	
<b>TOTAL FOR MAP NO. 34</b>										<b>3.5</b>	<b>0.07</b>				<b>72,996</b>	
2017CPT.05.22.20932.1	Warren	35	SR 1130 - PREACHER WILSON RD	SR 1129 - LARGO RD TO END MAINT	1	2		0.63	18	70	0.01					
<b>TOTAL FOR MAP NO. 35</b>										<b>0.63</b>	<b>0.01</b>					
2017CPT.05.22.20932.1	Warren	36	SR 1228 - HAWKS RD	SR 1229 - HEAVEN ST TO END OF PAVEMENT	1	2		1.59	20	178	0.03				33,496	
<b>TOTAL FOR MAP NO. 36</b>										<b>1.59</b>	<b>0.03</b>				<b>33,496</b>	
2017CPT.05.22.20932.1	Warren	37	SR 1238 - WELDON CAPPS RD	SR 1237 - MANSON-DREWRY RD TO CUL-DE-SAC	1	2		0.49	20	55	0.01					
<b>TOTAL FOR MAP NO. 37</b>										<b>0.49</b>	<b>0.01</b>					
2017CPT.05.22.20932.1	Warren	38	SR 1246 - LEROY GREEN RD	SR 1229 - HEAVEN ST TO END MAINT	1	2		0.32	18	35	0.01					
<b>TOTAL FOR MAP NO. 38</b>										<b>0.32</b>	<b>0.01</b>					
2017CPT.05.22.20932.1	Warren	39	SR 1315 - PETER STALLINGS RD	SR 1314 - WAVIELY THOMPSON RD TO SR 1309 - OAKVILLE RD	1	2		1.66	20	186	0.02				35,080	
<b>TOTAL FOR MAP NO. 39</b>										<b>1.66</b>	<b>0.02</b>				<b>35,080</b>	
2017CPT.05.22.20932.1	Warren	40	SR 1517 - LONG SCHOOL RD	SR 1521 - RUDD TRAIL TO NC 43	1	2		3.51	20	393	0.07				74,195	
<b>TOTAL FOR MAP NO. 40</b>										<b>3.51</b>	<b>0.07</b>				<b>74,195</b>	
<b>TOTAL FOR PROJ NO. 2017CPT.05.22.20932.1</b>										<b>11.7</b>	<b>1.309</b>	<b>0.22</b>			<b>215,767</b>	
5C.093050	Warren	41	SR 1529 - BIG REID RD	US 158 TO SR 1350 - JOHN SKINNER RD	3	2		0.99	20	12	0.01				21,106	
<b>TOTAL FOR MAP NO. 41</b>										<b>0.99</b>	<b>0.01</b>				<b>21,106</b>	
<b>TOTAL FOR PROJ NO. 5C.093050</b>										<b>0.99</b>	<b>0.01</b>				<b>21,106</b>	
<b>GRAND TOTAL</b>										<b>49.31</b>	<b>5.421</b>	<b>1.00</b>	<b>100</b>	<b>70</b>	<b>4</b>	<b>876,618</b>

## SIGNING FOR RESURFACING PROJECTS

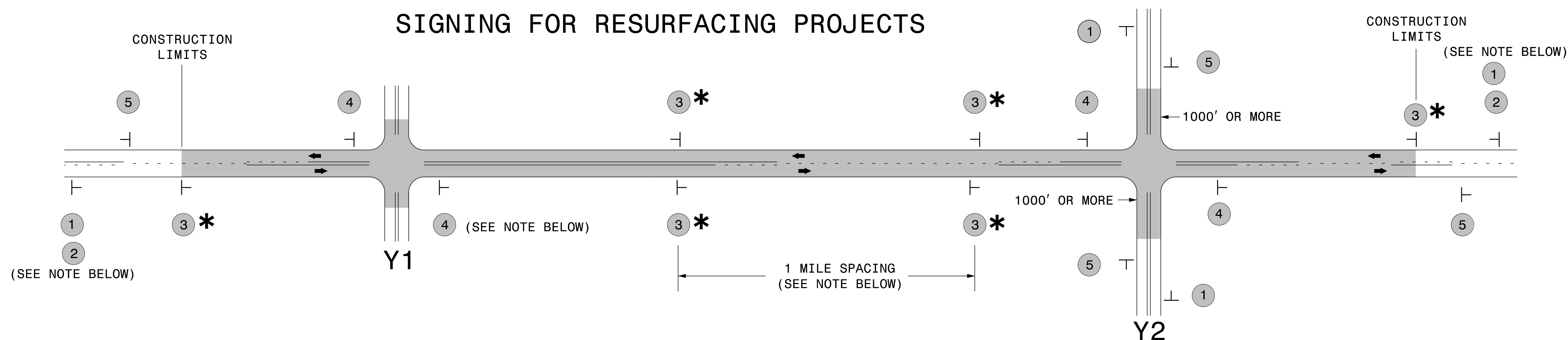

LEGEND	
┆	STATIONARY SIGN
←	DIRECTION OF TRAFFIC FLOW

### MAINLINE (-L-) SIGNING

### -Y- LINE SIGNING

SIGNING NOTES AND PLACEMENT PER DIRECTION		
1 2		<p style="text-align: center;"><b>NO REQUIRED STATIONARY SIGNING FOR THE FOLLOWING -Y- LINE CONDITIONS:</b></p> <ol style="list-style-type: none"> <li>1) LESS THAN 1000' OF RESURFACING ALONG -Y- LINE</li> <li>2) SUBDIVISION ROADS</li> <li>3) DEAD END ROADS</li> </ol> <p style="text-align: center;">WHEN PAVING/CONSTRUCTION ACTIVITIES PROCEED ACROSS AN UNSIGNED -Y- LINE, ADVANCE WARNING PORTABLE SIGNS SHALL BE USED ALONG THE -Y- LINE AS SHOWN BELOW. REMOVE UPON COMPLETION OF WORK.</p> <div style="display: flex; justify-content: space-around; align-items: center;"> <div style="text-align: center;"> <p>W20-1 48" X 48"</p> </div> <div style="text-align: center;"> <p>W20-7 A 48" X 48"</p> </div> </div> <p style="text-align: center;">PLACED 500' IN ADVANCE OF FLAGGER. PLACED 250' IN ADVANCE OF FLAGGER.</p>
3 *		
4		
5		

### \* SIGNING FOR ASPHALT SURFACE TREATMENTS (ONLY)

SUBSTITUTE LOW/SOFT SHOULDER SIGNS BY ALTERNATING THE FOLLOWING TWO SIGNS:  
STARTING WITH "UNMARKED PAVEMENT AHEAD" (SP 06026) FOLLOWED BY "LOOSE GRAVEL" (W8-7).



**RESURFACING  
ADVANCE WARNING SIGNS  
FOR  
RURAL AND SUBURBAN  
2 LANE ROADWAYS**